

Gulet

BONAVENTURA



ABOUT

Bonaventura's elegant hull, handcrafted mahogany interiors and furniture, stand as representative of the grace, class, and elegance of a traditional yacht, yet has the engineering and amenities of a modern one. The main saloon combines a dining area with an elegant bar and lounge seating area. The wooden floors, stylish furniture, and decent decorations create a comfortable and relaxing feeling. The saloon includes LED TV and DVD player. The sunbathing mattresses on the deck are perfect for sunbathing and relaxation while cruising and enjoying nature's beauties.

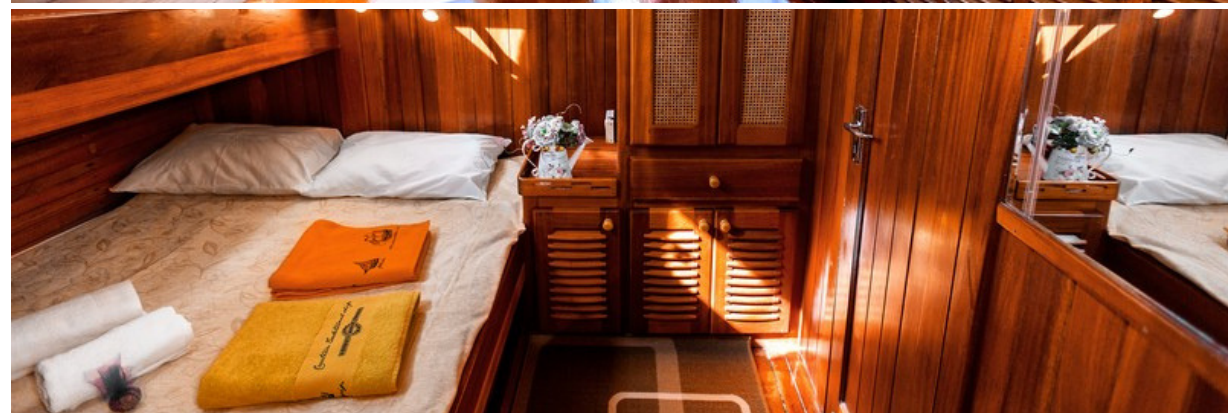

EXCLUDED:

- food
 - drinks/beverages
 - more than 4 hours of navigation per day
 - (additional hour 75 Eur/hr)
 - private marinas
 - port fees
 - more than 6 hours A/C per day (additional hour - 20 Eur/hour)
 - national park tickets
 - special ports of embarkation and disembarkation out of the base port,
 - one way cruise (optional)
-

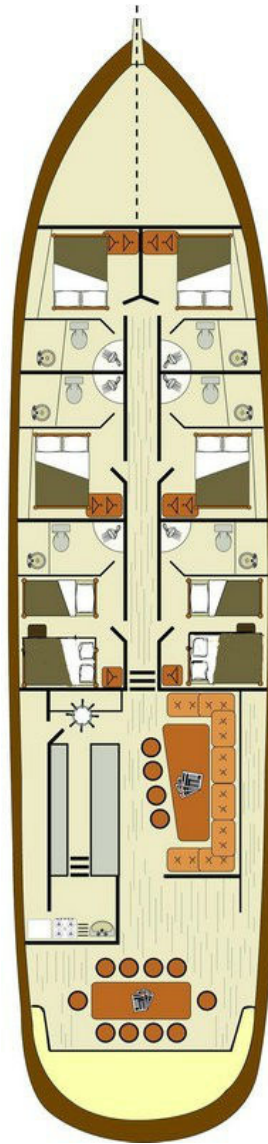

INCLUDED IN THE PRICE:

- week accommodation on board
 - all permits necessary for cruising
 - insurance
 - up to 4 hours cruising per day,
 - 3 crew members
 - bed sheets and towels,
 - beach towels
 - use of all boat's equipment (snorkeling equipment, canoe)
 - up to 6 hours A/C
 - room service
 - sojourn taxes
 - VAT
 - WiFi internet connection
-



FOOD OPTIONS

- **Half board**
(breakfast + lunch/dinner)
320 € per person/week
- **Half board fish menu**
(breakfast + lunch/dinner)
420 € per person/week
- **Full board** (breakfast, lunch, and dinner): 500 € per person/week.
- Children under 7 free of charge, children 7 – 12 years old - 50% discount

DRINK OPTIONS

- **All inclusive domestic package**
(water, soft drinks, tea, coffee, Croatian wines, beer, and spirits) 200€ /person/week
 - **All inclusive domestic non-alcoholic package** (water, soft drinks, coffee, tea) 100€ /person/week
 - **Service cost** for beverages supplied by clients = 700E per week
-